

BK 2000

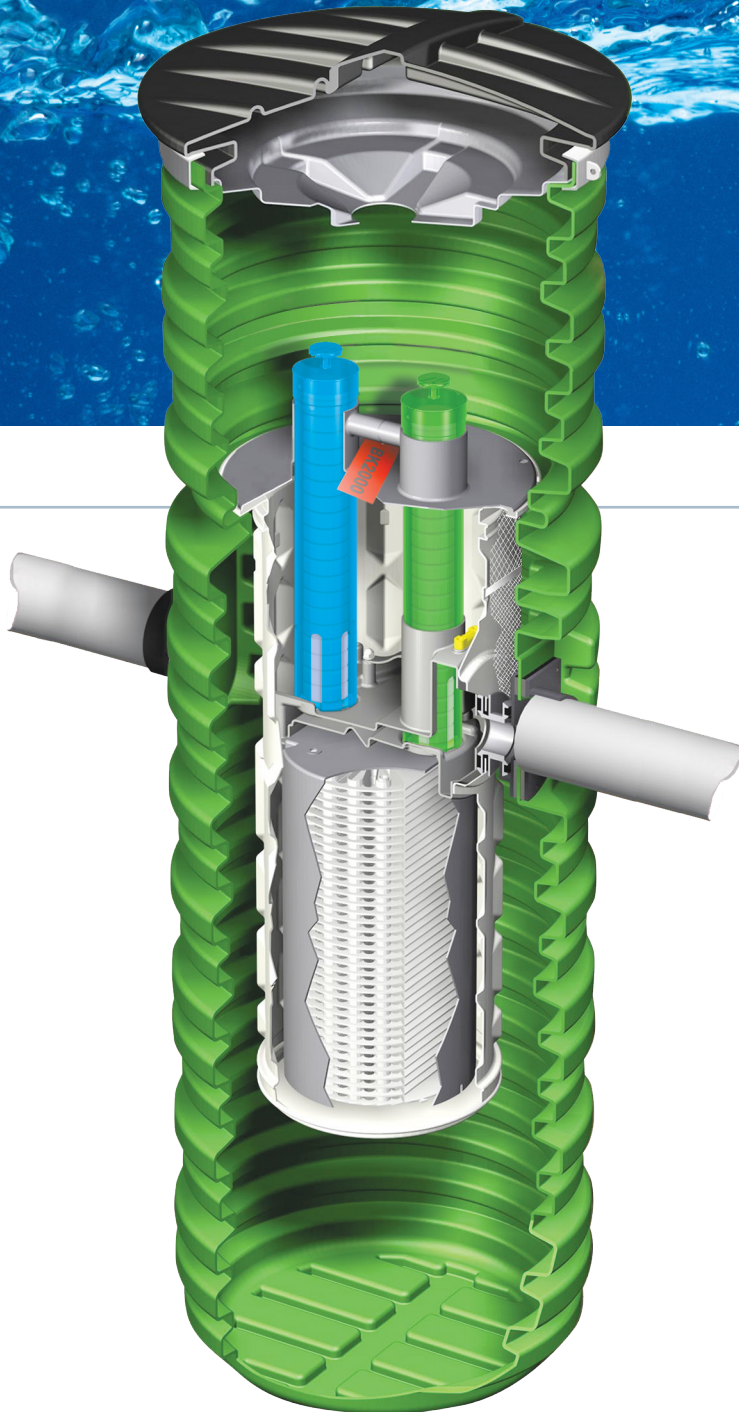

norweco[®]

*Engineering the future of water
and wastewater treatment*



BK 2000

the BIO-KINETIC[®] Wastewater Management System **protects**

property that's outside **municipal** sewer lines

Just because you live in an area that isn't served by municipal sewer lines, you don't have to endure all the problems that come with septic tanks. Bad odors, pollution, costly maintenance and failures are easily eliminated with the BK 2000, the wastewater management system that protects everything that is most important to you – your home, family and environment.

Wastewater management is a critical part of suburban and rural real estate development. Failures cause problems that are expensive to repair and damage that is hard to clean up. With so much at stake, it is vitally important to make the right water and wastewater treatment decision. We've been providing progress through service since 1906. When you consider the facts presented in this brochure, you'll see why Norweco is recognized as today's answer for the protection of tomorrow's environment.

solutions in wastewater treatment

How the BK 2000 System manages the treatment process

Heavy-Duty Access Cover

The cover, which is available in black or green to blend into your landscape, securely interlocks with the top rib of the Settling and Retention Basin. A locktab is provided to secure the cover and clamp. Unlike conventional treatment systems that are hard to access, the BK 2000 is easily maintained from grade. Routine annual inspections do not require tank pumping trucks, backhoes or confined space entry equipment. You can schedule inspections through a simple service contract with your local Norweco dealer or distributor, or with their authorized agent.

Baffled Perimeter Zone

The second of our 9 settling zones, the Baffled Perimeter Zone, is positioned immediately downstream from the Molded Filter Media to capture any contaminants that may have cleared the filter media.

Flow Deck

The Flow Deck with an adjustable outlet weir is just downstream of the six flow ports. Liquids entering and exiting the BK 2000 are held, controlled and directed by this Flow Deck.

Settling and Retention Basin

Constructed of corrosion-resistant polyethylene, the core basin is built to treat wastewater for a lifetime. Need more storage capacity? Simply add risers and more ring sections.

Safety/Service Guard

Located beneath the Access Cover, it prevents any accidental entry into the Basin and functions as a service funnel for routine maintenance.

Removable Moisture/Vapor Shield

This shield prevents condensation from entering the system. Built-in collars secure our optional chemical feed tubes.

Molded Filter Media

The Molded Filter Media traps and retains suspended solids that would otherwise plug your filter bed. These easy-to-clean filters function reliably for the life of the system.

Compartmented Settling Zone

It contains 42 chamber plates and 329 feet of kinetic filtration to establish a multidirectional plug flow path through the system.

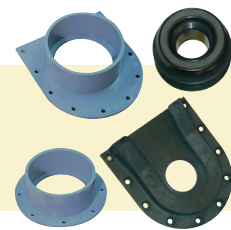
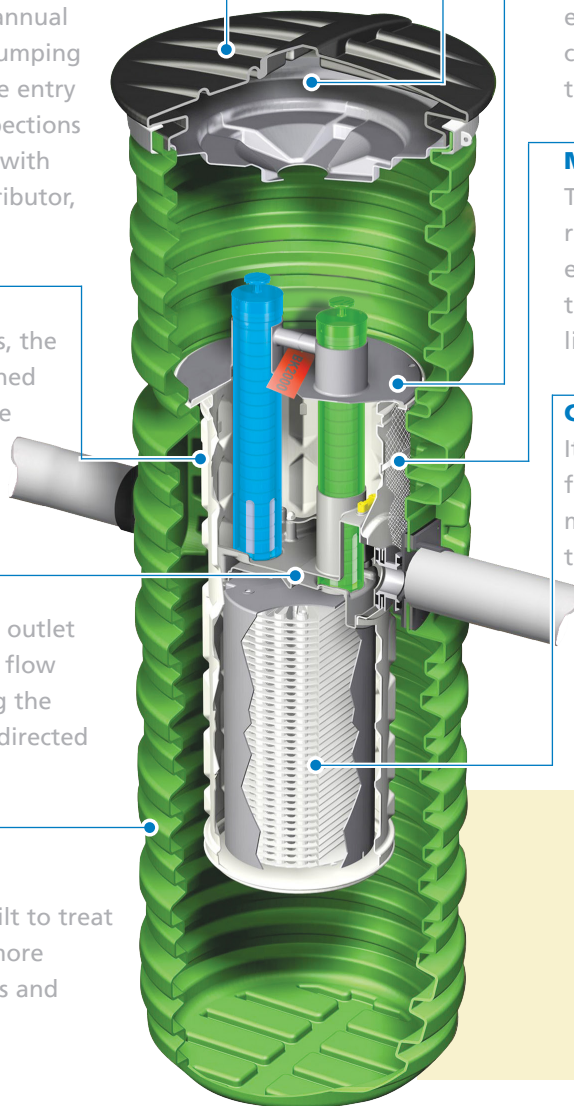

Hubs

HUBS ON OUR QUICK-DISCONNECT WITH ANTI-SHEAR INLET AND OUTLET PROVIDE A 4" SOCKET FOR SCHEDULE 40 PVC PIPE. A WATERTIGHT CONNECTION AND SIMPLE INSTALLATION AND REMOVAL ARE ASSURED BY A QUICK-DISCONNECT COUPLING.



customer focus

Your BK 2000 System is installed and maintained by your local, Norweco-trained Distributor. Every member of our team is fully trained and always at your service for worry-free support and protection.

Here are the pure facts:

- By equalizing flows up to 2,000 gallons per day, the BK 2000 reduces hydraulic and solids loading rates by more than 50%.
- The BK 2000 automatically doubles your system's performance and its operational life by eliminating solids washout and hydraulic overloads.
- It permits any conventional treatment method to fully utilize upstream tank capacity to store and treat accumulated wastewater. Even if you have to put up with marginal soils, high water tables, bedrock, heavy rains, hydraulic or organic overloads, the BK 2000 with its 3 filtration zones and 9 settling zones converts your septic tanks, tile fields, sand filters and other conventional treatment devices into advanced treatment solutions.
- The BK 2000 uses 6 Flow Equalization Ports to utilize upstream tank capacity, thus managing all heavy-use periods and hydraulic surges from clothes washers, dishwashers, water softeners, garbage disposals, baths, hot tubs, weekend guests and any other causes.
- With its unlimited design and installation flexibility, the BK 2000 serves a great variety of applications. All that's required is an area large enough to accommodate the Settling and Retention Basin and the connecting piping. Inlet and outlet piping connections are built-in, so installation is easily completed in just a few hours. There's no need for complicated excavation or landscaping. There are no complex pipe connections or electric hookups.
- The BK 2000 begins effectively managing up to 2,000 gallons of wastewater in its first day of operation. It will deliver a lifetime of protection.
- Only the BK 2000 combines filtration, solids retention and removal, flow equalization, optional chemical addition and simple maintenance for trouble-free, worry-free, long-term performance. The BK 2000 is installed with a 10-year warranty.
- U.S. and foreign patents are granted and pending.



NSF Certified Chlorine Dispenser

OUR BIO-KINETIC SYSTEM MAKES IT EASY TO PROPERLY DISINFECT OR DECHLORINATE THE WASTEWATER FLOW. WHEN USED WITH OUR BLUE CRYSTAL OR BIO-NEUTRALIZER TABLETS, IT'S LISTED UNDER NSF/ANSI STD. 46, SECTION 11 FOR SAFE, EFFECTIVE USE



Gasketed Rings and Extension Risers

THEY ARE AVAILABLE FOR INSTALLATIONS THAT REQUIRE ADDITIONAL BASIN CAPACITY OR DEPTH. RINGS AND RISERS ARE AVAILABLE IN HEIGHTS FROM 6" TO 72" AS REQUIRED.

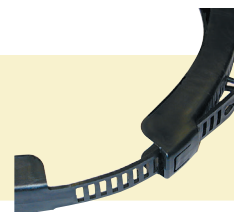

Molded Lockable Compression Clamp

IT LOCKS THE ACCESS COVER, RISER AND RING SECTIONS IN POSITION. THE CLAMP IS SECURED BY A STAINLESS STEEL FASTENER OR AN OPTIONAL PADLOCK



Norweco distributors are located throughout the United States and much of the rest of the world. Research, product development, manufacturing, marketing and sales support are conducted inside our offices and factory in Norwalk, Ohio. Everyone at Norweco is committed to shaping the future of our industry.

engineering

the future

of water and wastewater treatment

Specify BK 2000

Your local Norweco distributor is fully trained to install your BK 2000 System and any other Norweco product you choose to protect your environment. Our distributors have completed a nationally accredited BK 2000 factory-training program.

The BK 2000 System can be easily installed as part of any wastewater treatment system. The compact, easily transported basin is equipped with built-in connections for inlet and outlet piping, allowing installation to be completed in just hours. Extensive excavation work and revisions to existing landscaping are not required. There are no complex piping connections or electrical hookups. The BK 2000 System and its advanced treatment features begin working immediately.

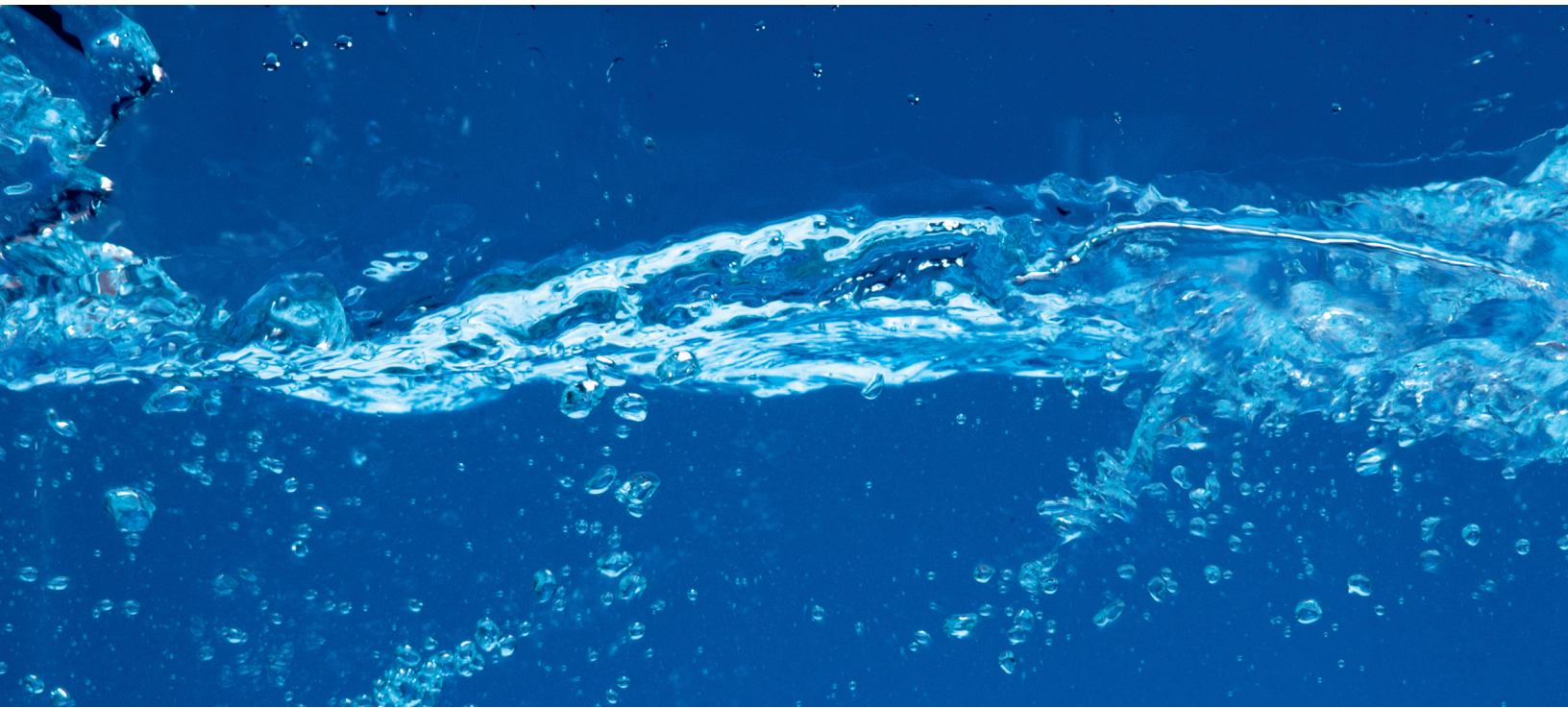

comprehensive protection, guaranteed



The BK 2000 is warranted against defects in material and workmanship under normal use and service for 10 full years. This limited warranty provides comprehensive, single source protection and covers all BK 2000 System components. Complete warranty information, a

Warranty Registration Card and Owner's Manual are included with purchase.

norweco[®]

*Engineering the future of water
and wastewater treatment*

**220 Republic Street
Norwalk, Ohio, U.S.A. 44857
PH: 419.668.4471
FAX: 419.663.5440
www.norweco.com**

Progress Through Service Since 1906

We engineer, manufacture, install, and maintain advanced water and wastewater treatment technologies for residential properties, communities, and commercial properties that are not connected to sewer lines. Norweco treatment systems are in service everywhere in the world.

Norweco[®], Norweco.com[®], Singulair[®], Modulair[®], Travalair[®], Singulair R3[®], Singulair Green[®], Ribbit Rivet[®], Hydro-Kinetic[®], Hydro-Kinetic Bio-Film Reactor[®], Evenair[®], Lift-Rail[®], Microsonic[®], Bio-Dynamic[®], Bio-Sanitizer[®], Bio-Neutralizer[®], Bio-Kinetic[®], Bio-Static[®], Bio-Gem[®], Bio-Max[®], Bio-Perce[®], Blue Crystal[®], Phos-4-Fade[®], Enviro-C[®], Nitro-Buster[®], ClearCheck[®], ChemCheck[®], Tri-Max[®], Hydra-Max[®], Service Pro[®], MCD[®], TNT[®], WASP[®], Grease Buster[®] and "BUSTER" logo are all registered trademarks of Norwalk Wastewater Equipment Company, Inc.